

TL2.5F
Standard Compressor
R134a
115V 60Hz

General

Code number	102G3206
Approvals	UL984
Compressors on pallet	125

Application

Application	LBP/MBP	
Frequency	Hz	50 60
Evaporating temperature	°F	— -13 to 23
Voltage range	V	— 103 - 127
Max. condensing temperature continuous (short)	°F	— 140 (158)
Max. winding temperature continuous (short)	°F	— 257 (257)

Cooling requirements

Frequency	Hz	50			60		
Application		LBP	MBP	HBP	LBP	MBP	HBP
90°F		—	—	—	S	S	—
100°F		—	—	—	S	S	—
110°F		—	—	—	S	S	—
Remarks on application:							

Motor

Motor type		RSIR	
LRA (rated after 4 sec. UL984), HST LST	A	–	5.3
Cut in Current, HST LST	A	–	14.5
Resistance, main start winding (77°F)	Ω	7.3	4.8

Design

Displacement	cu.in	0.16
Oil quantity (type)	fl.oz.	6.1 (polyolester)
Maximum refrigerant charge	oz.	14.0
Free gas volume in compressor	fl.oz.	54.2
Weight without electrical equipment	lbs.	14.7

Dimensions

Dimensions		Dimensions	
Height	inch	A	6.42
		B	6.26
		B1	–
		B2	–
Suction connector	location, I.D. in. angle	C	0.252-0.259 30°
	material comment	Copper Rubber plug	
Process connector	location, I.D. in. angle	D	0.252-0.259 31.5°
	material comment	Copper Rubber plug	
Discharge connector	location, I.D. in. angle	E	0.202-0.205 28°
	material comment	Copper Rubber plug	
Oil cooler connector	location, I.D. in. angle	F	–
	material comment	–	
Remarks:			

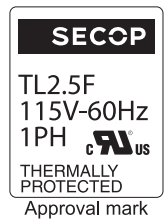
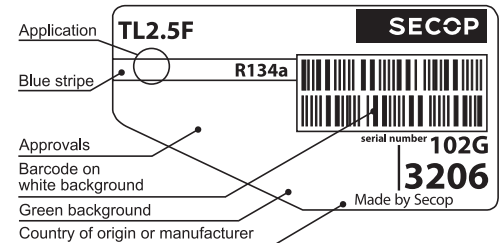

S = Static cooling normally sufficient
O = Oil cooling
F₁ = Fan cooling 1.5 m/s
(compressor compartment temperature
equal to ambient temperature)
F₂ = Fan cooling 3.0 m/s necessary
SG = Suction gas cooling normally sufficient
– = not applicable in this area

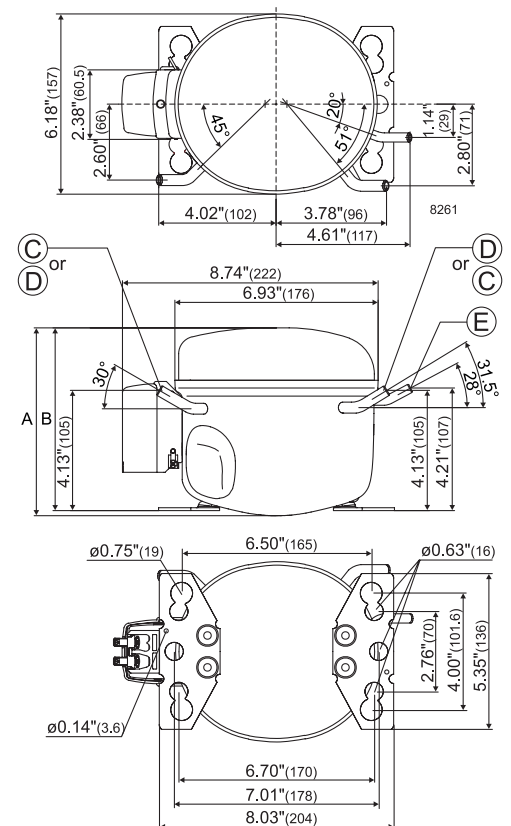

ASHRAE LBP

115V, 60Hz, static cooling

Evap. temp. in °F	-49	-40	-30	-20	-13	-10	0	10	14	20	30	40	41	45	50	59	68
Capacity in BTU/h					181	202	287	396	445	524							
Power cons. in W					61	65	77	90	95	104							
Current cons. in A					0.91	0.94	1.00	1.08	1.13	1.22							
EER in BTU/Wh					2.96	3.11	3.73	4.42	4.69	5.05							

ASHRAE MBP

115V, 60Hz, static cooling

Evap. temp. in °F	-49	-40	-30	-20	-13	-10	0	10	14	20	30	40	41	45	50	59	68
Capacity in W					162	180	255	354	397	466							
Power cons. in W					61	65	77	90	95	104							
Current cons. in A					0.91	0.94	1.00	1.08	1.13	1.22							
COP in W/W					2.63	2.77	3.32	3.93	4.18	4.49							

EN 12900 Household (CECOMAF) 115V, 60Hz, static cooling

Evap. temp. in °F	-49	-40	-30	-20	-13	-10	0	10	14	20	30	40	41	45	50	59	68
Capacity in W					43	48	68	93	105	124							
Power cons. in W					61	65	77	90	95	104							
Current cons. in A					0.91	0.94	1.00	1.08	1.13	1.22							
COP in W/W					0.70	0.74	0.88	1.04	1.11	1.19							

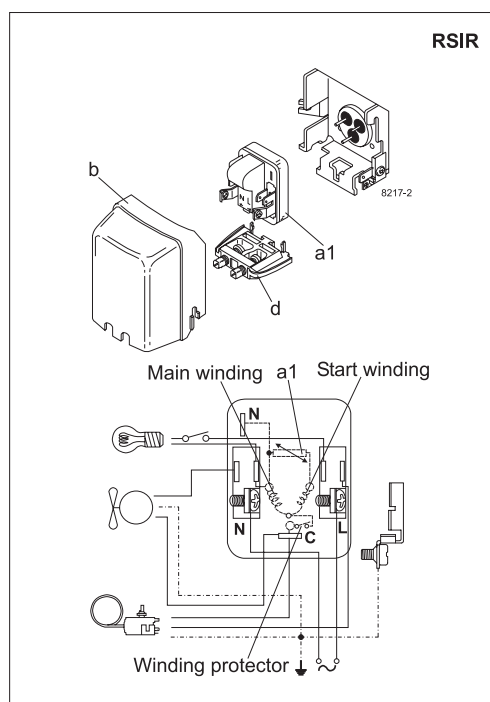

Accessories for	TL2.5F	Figure	Code number	Test conditions	ASHRAE LBP	ASHRAE MBP	EN 12900/CECOMAF
PTC starting device	1/4 in. spade connect. 3/16 in. spade connect.	a1	103N0026 103N0023	Condensing temp.	130°F	130°F	131°F
Cover		b	103N2011	Ambient temp.	90°F	95°F	90°F
Cord relief		d	103N1010	Suction gas temp.	90°F	95°F	90°F
				Liquid temperature	90°F	115°F	no subcooling

Mounting accessories	Code number
Bolt joint for one comp. Ø: 5/8 in.	118-1917
Bolt joint in quantities Ø: 5/8 in.	118-1918
Snap-on in quantities Ø: 5/8 in.	118-1919

Nidec GA Compressors accepts no responsibility for possible errors in catalogs, brochures, and other printed material. Nidec GA Compressors reserves the right to alter its products without notice. This also applies to products already on order provided that such alterations can be made without substantial changes being necessary to specifications already agreed. All trademarks in this material are the property of the respective companies. Secop and the Secop logotype are trademarks of Nidec Global Appliance Germany GmbH. All rights reserved. www.secop.com